

NOTE: HANDICAP PARKING SPACES MUST NOT EXCEED A 2% CROSS SLOPE (TYP)

PARKING STALLS DETAILS
N.T.S.

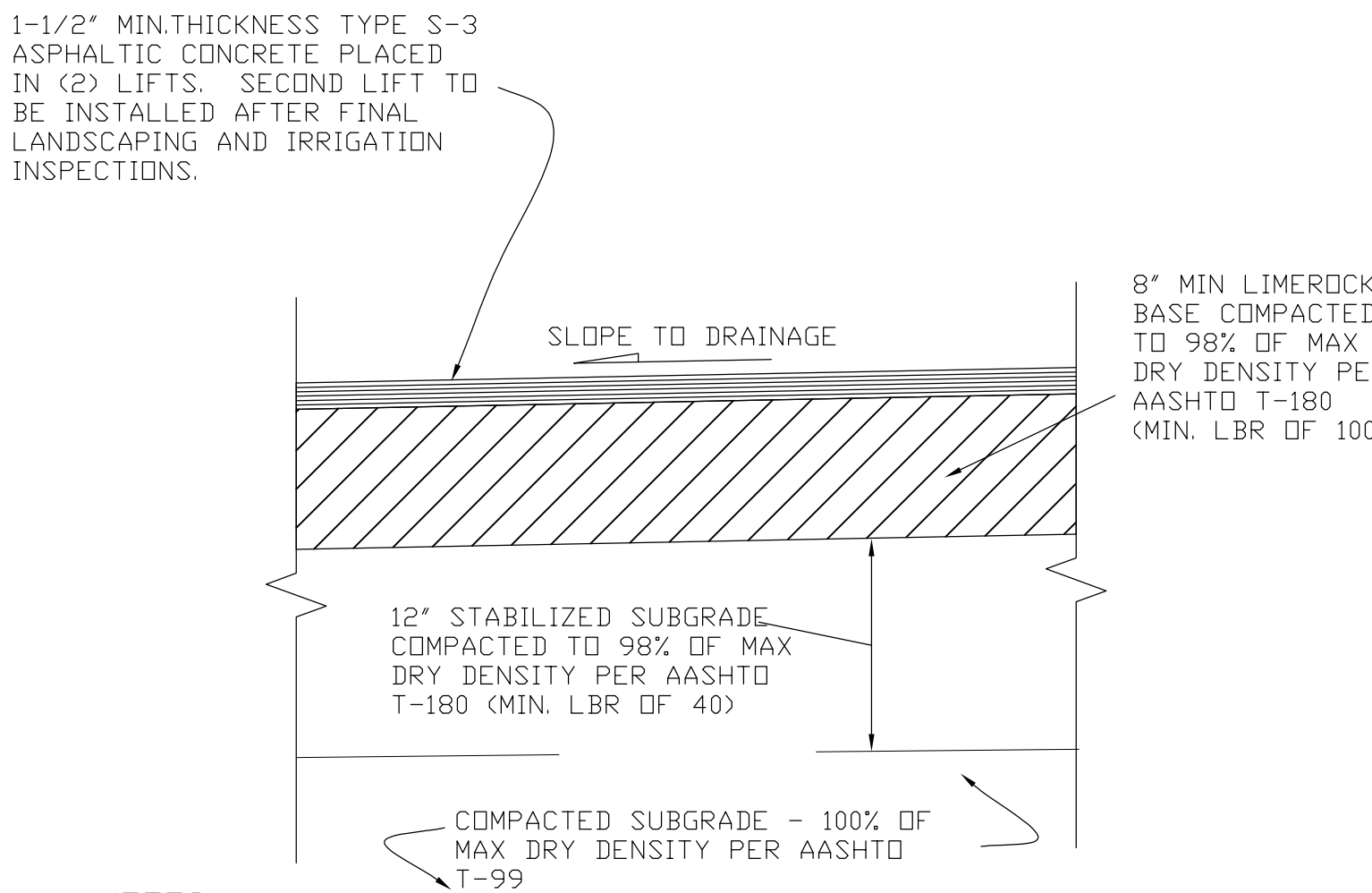

- NOTES:
1. STABILIZED SUBGRADE SHALL HAVE A MINIMUM LIMEROCK BEARING RATIO (LBR) OF 40 AND IS REQUIRED FOR ALL NEW PAVEMENT CONSTRUCTION. ALL STABILIZED SUBGRADE SHALL BE STRING LINED FOR GRADE AND PASS ALL REQUIRED DENSITY TESTING PRIOR TO PLACEMENT OF LIMEROCK BASE.
 2. LIMEROCK BASE FOR PARKING LOTS SHALL BE A MINIMUM OF 70% CARBONATES OF CALCIUM AND MAGNESIUM.
 3. PRIME COAT SHALL BE APPLIED TO ALL FINISHED LIMEROCK BASE SURFACES AFTER BOARDING AND DENSITY INSPECTIONS. APPLICATION RATES AND MATERIALS SHALL BE IN ACCORDANCE WITH FDOT SPECIFICATIONS.
 4. TACK COAT SHALL BE PLACED BETWEEN SURFACE LIFTS. APPLICATION RATES AND MATERIALS SHALL BE IN ACCORDANCE WITH FDOT SPECIFICATIONS.
 5. THE FINAL PAVEMENT LIFT SHOULD NOT BE PLACED UNTIL ALL PROJECT LANDSCAPING IS IN PLACE AND THE IRRIGATION SYSTEM IS FINALED.

ASPHALTIC CONCRETE PAVEMENT DETAIL
N.T.S.

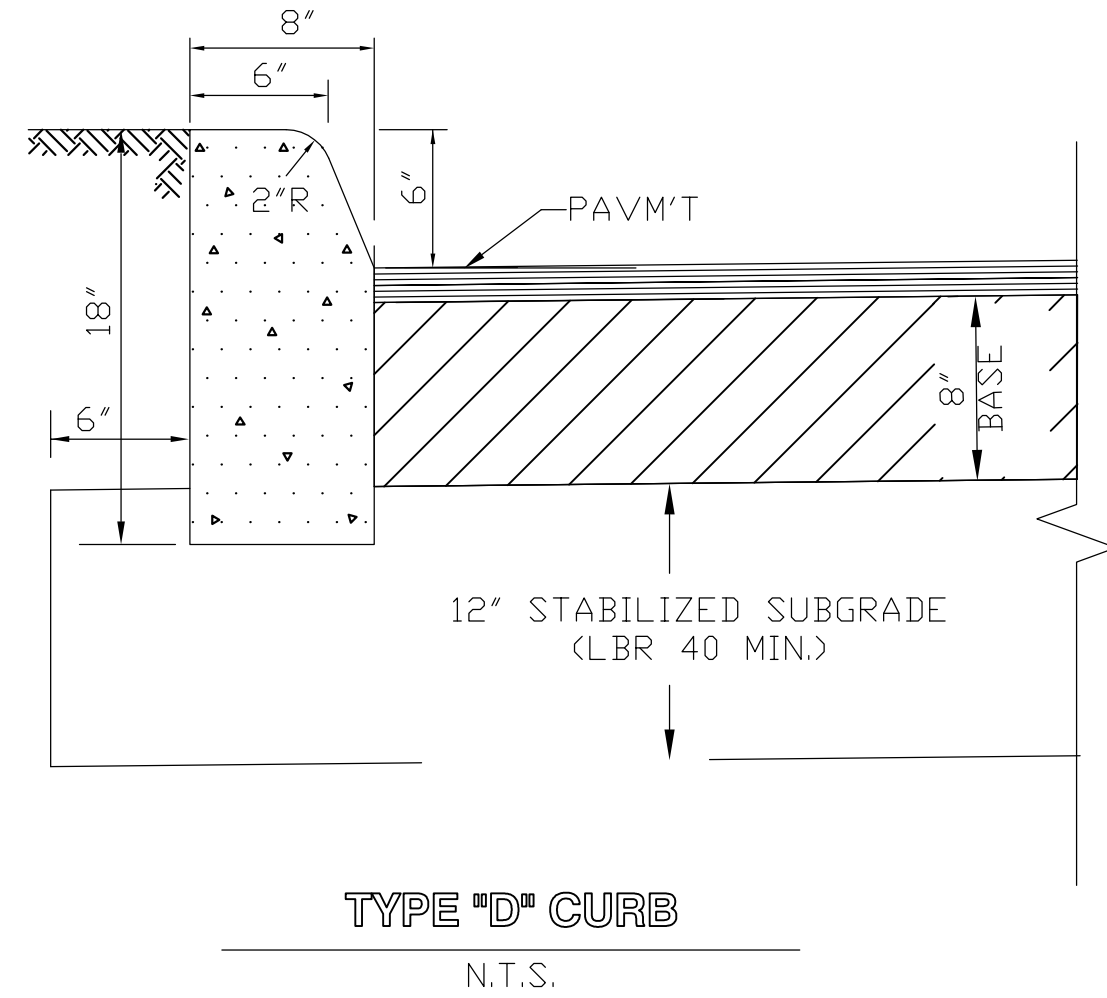

- CURB NOTES:
1. PROVIDE 1/4" WIDE CONTRACTION JOINT A MINIMUM OF 1-1/2" DEEP AND AT 10' SPACING MAXIMUM FOR ALL CURBS.
 2. CONCRETE SHALL BE 3000 P.S.I. MIN. @ 28 DAYS.
 3. TYPE "D" CURB FOR PARKING LOTS MAY BE INSTALLED AS "TRENCHED" D CURB WITH EXTRUDED TOP AT THE CONTRACTOR'S OPTION. TRENCHED CURB REQUIRES CITY TRENCH INSPECTION AND APPROVAL. EXTRUDED CURB MUST BE PLACED WITHIN 15 MINUTES OF PLACEMENT OF TRENCH CONCRETE. EXTRUDED CURB AND TRENCH CONCRETE SHALL BE MONOLITHIC.

TYPE "D" CURB DETAIL
N.T.S.

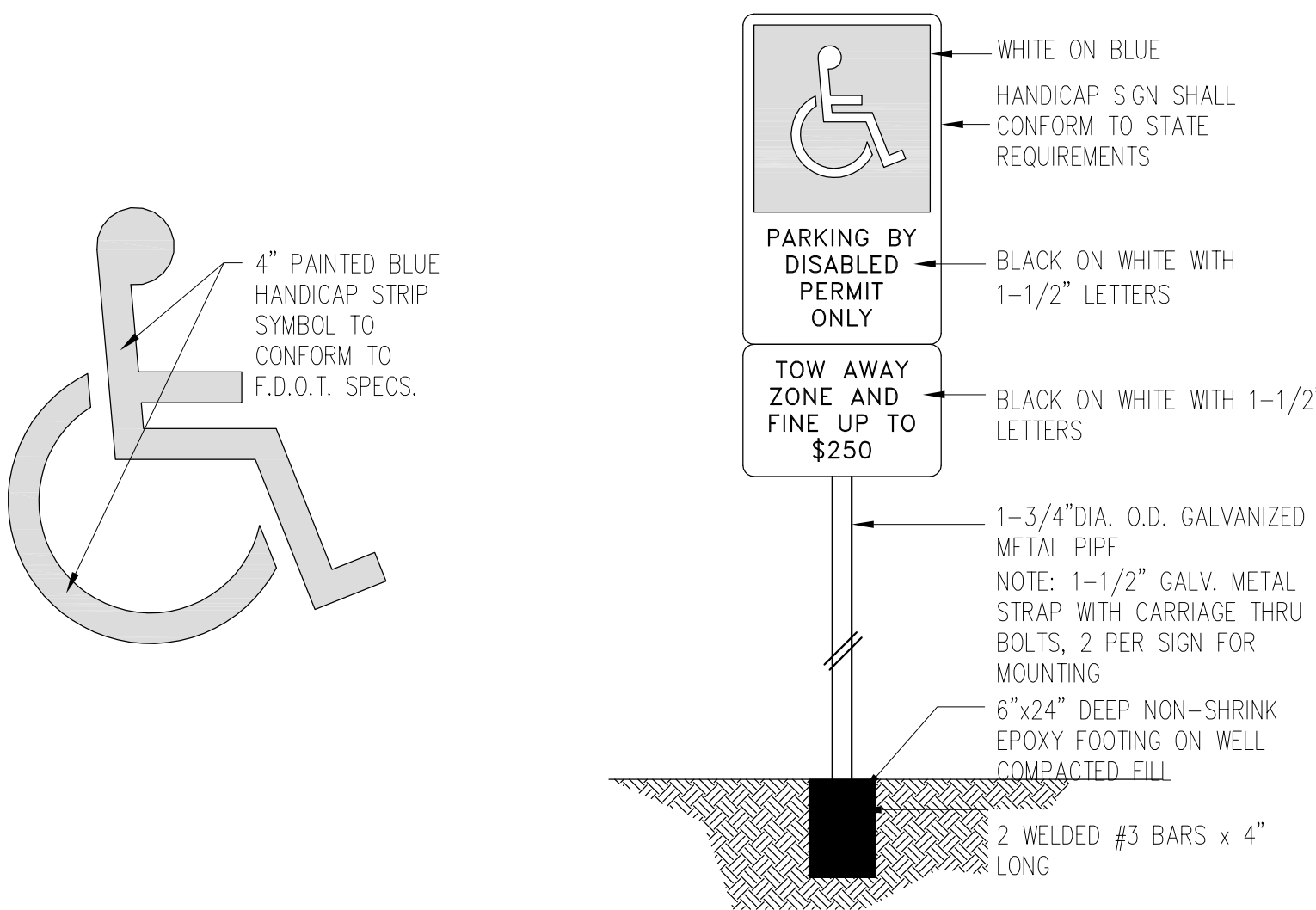

NOTE: PROVIDE ONE SIGN FOR EACH HANDICAP SPACE.

HC SIGNAGE & MARKING DETAILS
N.T.S.

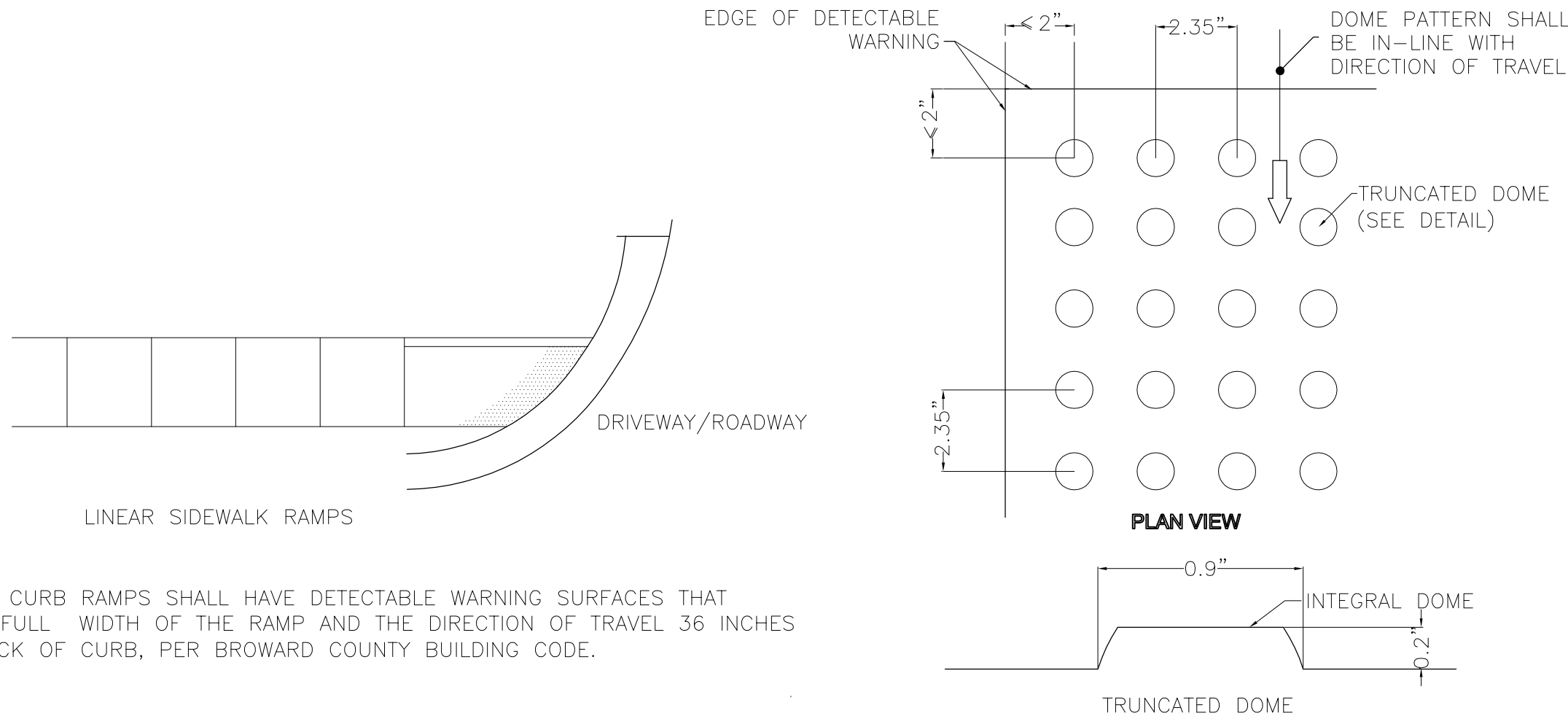

ALL SIDEWALK CURB RAMPS SHALL HAVE DETECTABLE WARNING SURFACES THAT EXTENDS THE FULL WIDTH OF THE RAMP AND THE DIRECTION OF TRAVEL 36 INCHES FROM THE BACK OF CURB, PER BROWARD COUNTY BUILDING CODE.

CURB RAMP DETECTABLE WARNING
N.T.S.

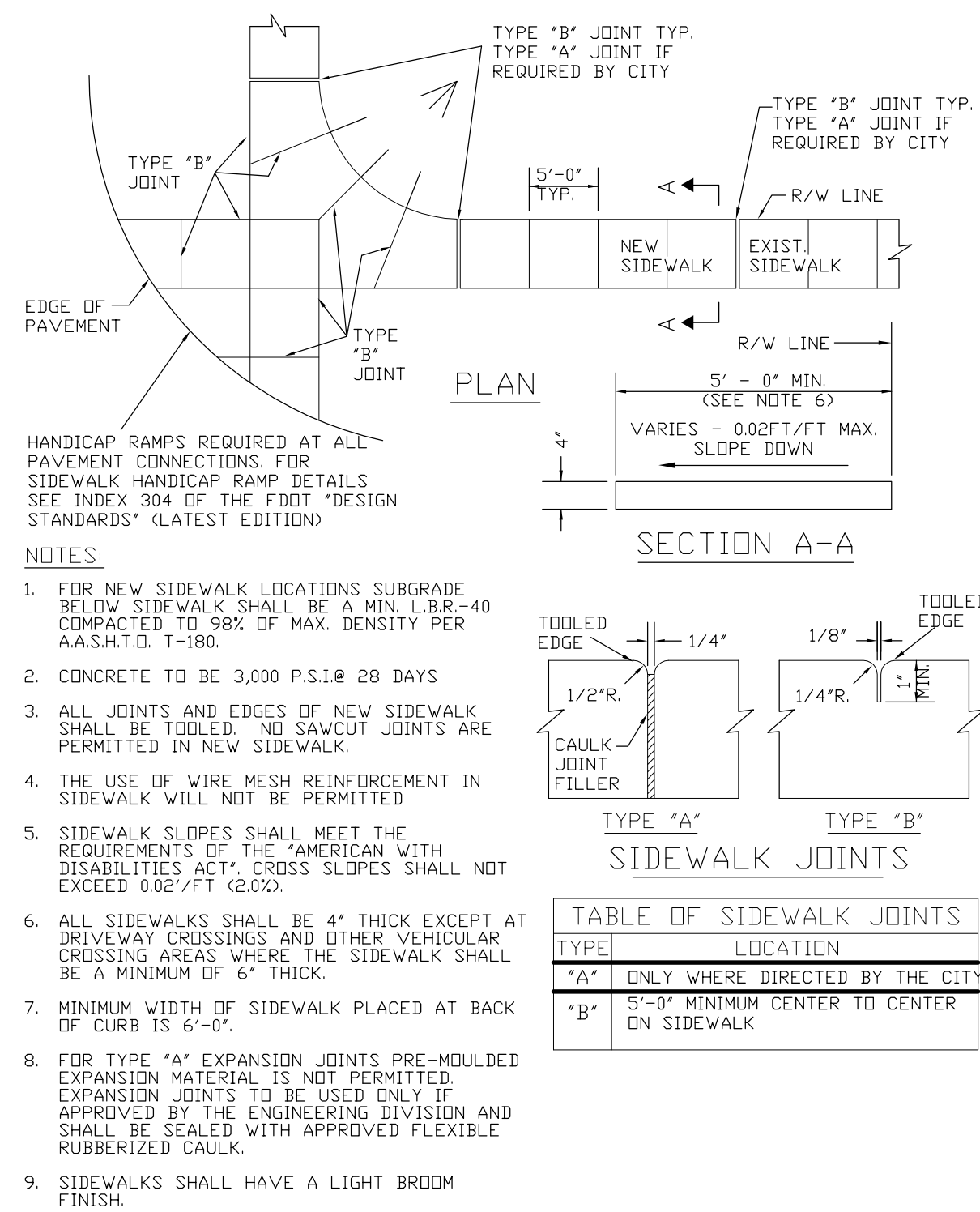

- NOTES:
1. FOR NEW SIDEWALK LOCATIONS SUBGRADE BELOW SIDEWALK SHALL BE A MIN. L.B.R.-40 COMPACTED TO 98% OF MAX. DENSITY PER A.A.S.H.T.O. T-180.
 2. CONCRETE TO BE 3,000 P.S.I. @ 28 DAYS
 3. ALL JOINTS AND EDGES OF NEW SIDEWALK SHALL BE TOOLED. NO SAWCUT JOINTS ARE PERMITTED IN NEW SIDEWALK.
 4. THE USE OF WIRE MESH REINFORCEMENT IN SIDEWALK WILL NOT BE PERMITTED
 5. SIDEWALK SLOPES SHALL MEET THE REQUIREMENTS OF THE AMERICAN WITH DISABILITIES ACT. CROSS SLOPES SHALL NOT EXCEED 0.02%/FT (2/100).
 6. ALL SIDEWALKS SHALL BE 4" THICK EXCEPT AT DRIVEWAY CROSSINGS AND OTHER VEHICULAR CROSSING AREAS WHERE THE SIDEWALK SHALL BE A MINIMUM OF 6" THICK.
 7. MINIMUM WIDTH OF SIDEWALK PLACED AT BACK OF CURB IS 6'-0"
 8. FOR TYPE "A" EXPANSION JOINTS PRE-MOULDED EXPANSION MATERIAL IS NOT PERMITTED. EXPANSION JOINTS TO BE USED ONLY IF APPROVED BY THE ENGINEERING DIVISION AND SHALL BE SEALED WITH APPROVED FLEXIBLE RUBBERIZED CAULK.
 9. SIDEWALKS SHALL HAVE A LIGHT BROOM FINISH.

SIDEWALK CONSTRUCTION DETAIL
N.T.S.



GATOR ENGINEERING
ASSOCIATES, INC.
11880 TEMPLE STREET
CORAL GABLES, FL 33156
TEL: (305) 434-5800 FAX: (305) 434-5904
CERTIFICATE OF AUTHORIZATION NUMBER 30230

Regina Bobo-Jackson
DATE: 11/17/2021
FILE NO.: 38550

PARKING LOT
NW 6TH AVENUE & NW 6TH STREET
POMPANO BEACH, FLORIDA

REVISIONS	DATE	DESCRIPTION

GEA PROJECT NO.: 20093
DATE: 11-06-2020
SCALE: AS SHOWN
DESIGNED BY: R.B.J.
DRAWN BY: L.B.
CHECKED BY: R.B.J.
APPROVED BY: R.B.J.

SHEET TITLE
DETAILS
1 OF 4

DRC
PZ21-12000017
11/17/2021